



LOBBY LEVEL

Name of Room	Total Sq. Ft.	Dimensions	Ceiling Ht.	Classroom	Theatre	Crescent	Banquet	Conference
International Ballroom	9,588	91' x 104'	14'	590	1,000	400	250	48
Manchester	2,209	47' x 47'	14'	100	200	70	150	48
Geneva	2,209	47' x 47'	14'	150	240	100	200	54
Gloucestershire	2,185	47' x 50'	14'	120	210	90	150	66
Windsor	2,525	47' x 53'	14'	180	330	110	240	54
Council Oak Ballroom	2,365	50' x 43'	12'	150	240	120	200	60
Russell	946	22' x 43'	12'	50	80	50	80	36
Woodward	1,419	33' x 43'	12'	100	150	70	120	48
Keystone	200	15' x 13'	9'6"	-	10	-	12	8
Remington	800	20' x 40'	9'6"	40	80	35	50	30
Gilcrease	700	35' x 20'	9'6"	40	70	30	50	24
Philbrook	400	20' x 20'	9'6"	18	35	18	30	16
Regency Ballroom	612	181' x 34'	8'	-	-	-	-	12
International Foyer	3,774	102' x 37'	-	-	-	-	-	-
Council Oak Foyer	1,280	64' x 20'	-	-	-	-	-	-

SECOND FLOOR

Name of Room	Total Sq. Ft.	Dimensions	Ceiling Ht.	Classroom	Theatre	Crescent	Banquet	Conference
Second Floor Ballroom	2,349	81' x 29'	9'9"	100	170	84	120	68
Dover	648	27' x 24'	9'9"	30	55	30	40	24
Westminster	672	28' x 24'	9'9"	30	55	30	40	24
Coventry	648	27' x 24'	9'9"	30	55	30	40	24
Second Floor Conference Room	351	19' x 19'	9'6"	18	30	18	24	16
Second Floor Balcony	1,760	22' x 80'	9'6"	-	-	-	50	-

LOBBY LEVEL

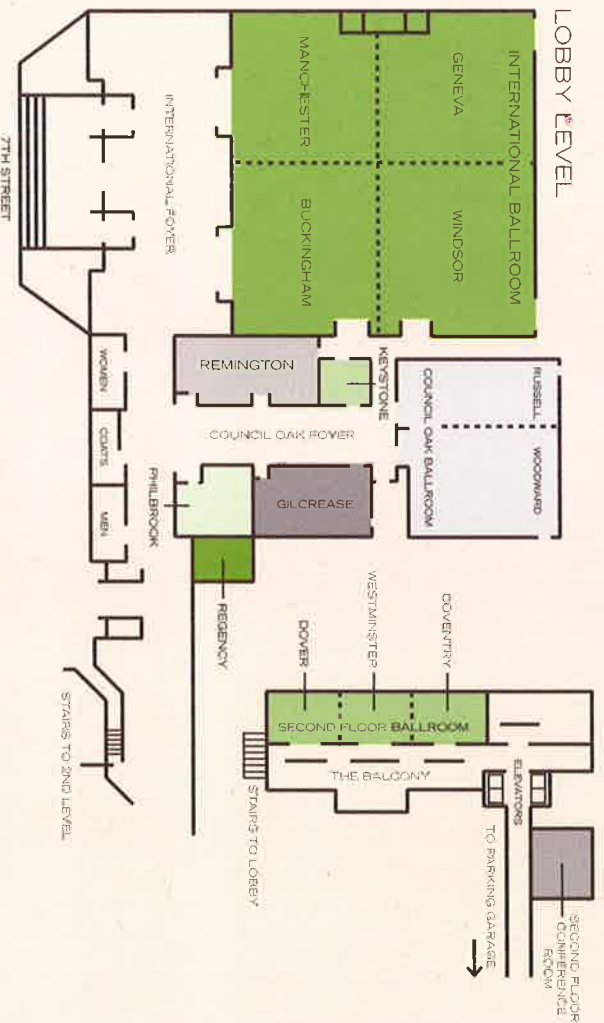

DOUBLE TREE BY HILTON TULSA DOWNTOWN  
 616 W. Seventh Street Tulsa, OK 74127-8983 (918) 587 8000  
 TULSD\_DS@hilton.com | TulsaDowntown.DoubleTree.com

100% POST CONSUMER  
 RECYCLED PAPER

GDS CODES:  
 Amadeus: TULDDT  
 Apollo/Galileo: 19026  
 Sabre: 9689  
 Worldspire: TULDD